

FICHE D'HOMOLOGATION / HOMOLOGATION FORM



047-TO-99



COMMISSION
INTERNATIONALE
DE KARTING - FIA

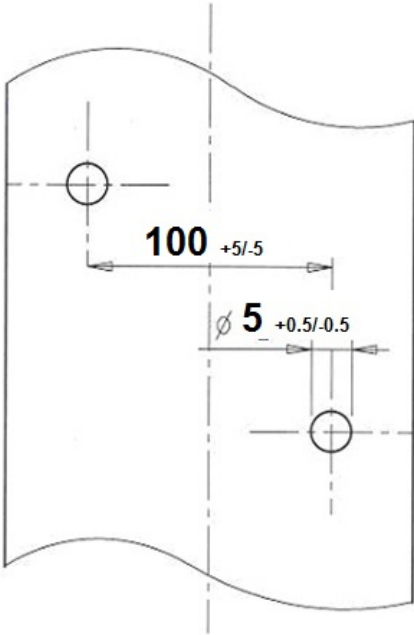

PNEUMATIQUE / TYRE 5" SLICK OPTION

Constructeur / Manufacturer	VEGA S.r.l.
Marque / Make	VEGA
Modèle / Model	XH3 CIK Option 11x7.10-5
Catégorie / Category	Group 1 & 2
Durée de l'homologation / Validity of the Homologation	3 ans / 3 years
Nombre de pages / Number of pages	4
La présente Fiche d'Homologation reproduit descriptions, illustrations et dimensions du pneumatique au moment de l'homologation CIK-FIA et du test d'homologation.	<i>This Homologation Form reproduces descriptions, illustrations and dimensions of the tyre at the moment of the CIK-FIA homologation and of the homologation test.</i>
	
Photo du pneu monté sur la jante / Photo of the tyre fitted to the rim	Dessin de la bande de roulement / Tread design drawing
Signature et tampon de l'ASN / Signature and stamp of the ASN	Signature et tampon de la CIK-FIA / Signature and stamp of the CIK-FIA
	

Descriptions Techniques	Technical Descriptions
Sous une température de 23°C +/-2°C, avec une humidité de 50% +/-5%	At a temperature of 23°C +/-2°C and with a humidity of 50% +/-5%

Pt	Descriptions / Descriptions	Valeurs / Value		Tolérances / Tolerances	
1	Dimensions / Dimensions	11 x 7.10-5		--	
2	Désignation du mélange / Tread compound designation	XH3 CIK Option		--	
3	Pression de service / Service pressure	1.1 bar		+/- 0.3 bar	
4	Pression de gonflage / Inflation pressure	4 Bar		max	
5	Capacité de charge / Load capacity	100 kg		max	
6	Vitesse maximale / Maximum speed	180 km/h			
7	Rigidité latérale et verticale (sous charge de 40 kg) / Lateral and vertical stiffness (under 40 kg load)	L = 3, V = 16 mm		L: +/-1 V: +/-2	
8					
9	Profondeur du profil / Depth of tread	3.7 mm		+/- 0.5 mm	
10	Poids en grammes / Weight in grams	1680		+/- 10%	
11	Nombre de plis / Numbers of plies	2		--	
12	Épaisseur de la bande de roulement / Tread thickness	4.2 mm		+/- 1.0 mm	
13	Nombre d'indicateurs d'usure du pneu / Number of tread wear indicators	6		--	
14	Matériau de la carcasse / Carcass material	Polyester		--	
15	Angle de tissage de la toile du pneu / Angle of tyre canvas	34°		+/- 3°	
16	Type de fil de tissage (selon ISO) / Canvas thread type (according to ISO)	1670		--	
17	Pneu tubeless / Tubeless tyre	Yes		--	
18	Dureté superficielle de la bande de roulement (ISO 48: 2018 – 2 échantillons de 2 mm d'épaisseur) / Superficial tread hardness (ISO 48: 2018 – 2 samples of 2 mm thickness)	41.0		+/- 5 DIDC - IRHD	
19	Contrainte-déformation en traction (ISO 37:2017 – éprouvette type 3) / Tensile stress-strain (ISO 37:2017 – type 3 sample)	à / at 100%	à / at 300%	à / at 100%	à / at 300%
		1.3	6.5	+/- 0.5 MPa	+/- 0.8 MPa

Dessin	Drawing
---------------	----------------

Dessin du pneu en section transversale et dimensions du pneu monté sur une jante / <i>Drawing of tyre cross section and dimensions of the tyre fitted to a rim</i>	Dimensions / <i>Dimensions</i>	Tolérances / <i>Tolerances</i>
	Ø 274 mm	+/- 5 mm
	Ø 126.2 * mm	+0/-1.0 mm
	179 mm	+/- 5 mm
	207 mm	+/- 5 mm
	198 mm	+/- 5 mm
*Dimension selon Dessin Technique N° 4 jante 5" standardisée / <i>Dimension according to Technical Drawing N° 4 standardised 5" rim</i>		

DESSIN TECHNIQUE N°4

Jante 5"

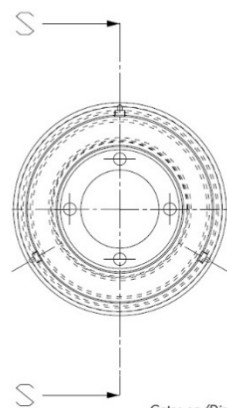



Cotes en/Dimensions in mm

TECHNICAL DRAWING No. 4

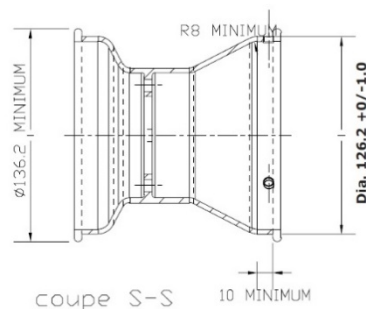
5" Rim



coupe S-S

Photos et Inscriptions	<i>Photos and Inscriptions</i>																																
Seules les inscriptions qui ne changeront pas tout au long de la fabrication sont reportées ci-dessous.	<i>Only inscriptions which will not change during production are mentioned below.</i>																																
Photo du flanc extérieur du pneu / <i>Photo of tyre external sidewall</i>	Inscription sur le flanc extérieur du pneu / <i>Inscriptions on tyre external sidewall</i>																																
	<table border="1"> <thead> <tr> <th data-bbox="799 692 1150 748">Texte / Text</th> <th data-bbox="1155 692 1331 748">Hauteur / Height</th> <th data-bbox="1335 692 1481 748">Trait / Stroke</th> </tr> </thead> <tbody> <tr> <td data-bbox="799 754 1150 792">VEGA (printed)</td> <td data-bbox="1155 754 1331 792"></td> <td data-bbox="1335 754 1481 792"></td> </tr> <tr> <td data-bbox="799 799 1150 837">XH3 >></td> <td data-bbox="1155 799 1331 837">13 mm</td> <td data-bbox="1335 799 1481 837">3/5 mm</td> </tr> <tr> <td data-bbox="799 844 1150 882">10 x 7.10 – 5</td> <td data-bbox="1155 844 1331 882">10 mm</td> <td data-bbox="1335 844 1481 882">4 mm</td> </tr> <tr> <td data-bbox="799 889 1150 972">Max inflation pressure 4 bar</td> <td data-bbox="1155 889 1331 972">3.8 mm</td> <td data-bbox="1335 889 1481 972">1 mm</td> </tr> <tr> <td data-bbox="799 978 1150 1016">Barcode</td> <td data-bbox="1155 978 1331 1016"></td> <td data-bbox="1335 978 1481 1016"></td> </tr> <tr> <td data-bbox="799 1023 1150 1061"></td> <td data-bbox="1155 1023 1331 1061"></td> <td data-bbox="1335 1023 1481 1061"></td> </tr> <tr> <td data-bbox="799 1068 1150 1106"></td> <td data-bbox="1155 1068 1331 1106"></td> <td data-bbox="1335 1068 1481 1106"></td> </tr> <tr> <td data-bbox="799 1113 1150 1151"></td> <td data-bbox="1155 1113 1331 1151"></td> <td data-bbox="1335 1113 1481 1151"></td> </tr> <tr> <td data-bbox="799 1158 1150 1196"></td> <td data-bbox="1155 1158 1331 1196"></td> <td data-bbox="1335 1158 1481 1196"></td> </tr> </tbody> </table>	Texte / Text	Hauteur / Height	Trait / Stroke	VEGA (printed)			XH3 >>	13 mm	3/5 mm	10 x 7.10 – 5	10 mm	4 mm	Max inflation pressure 4 bar	3.8 mm	1 mm	Barcode																
	Texte / Text	Hauteur / Height	Trait / Stroke																														
	VEGA (printed)																																
	XH3 >>	13 mm	3/5 mm																														
	10 x 7.10 – 5	10 mm	4 mm																														
	Max inflation pressure 4 bar	3.8 mm	1 mm																														
	Barcode																																
Photo du flanc intérieur du pneu / <i>Photo of tyre internal sidewall</i>	Inscription sur le flanc intérieur du pneu / <i>Inscriptions on tyre internal sidewall</i>																																
	<table border="1"> <thead> <tr> <th data-bbox="799 1451 1150 1507">Texte / Text</th> <th data-bbox="1155 1451 1331 1507">Hauteur / Height</th> <th data-bbox="1335 1451 1481 1507">Trait / Stroke</th> </tr> </thead> <tbody> <tr> <td data-bbox="799 1514 1150 1552">VEGA</td> <td data-bbox="1155 1514 1331 1552">16.5 mm</td> <td data-bbox="1335 1514 1481 1552">4.5/9.5</td> </tr> <tr> <td data-bbox="799 1559 1150 1597">10 x 7.10 – 5</td> <td data-bbox="1155 1559 1331 1597">10 mm</td> <td data-bbox="1335 1559 1481 1597">4 mm</td> </tr> <tr> <td data-bbox="799 1603 1150 1641">Made in Italy</td> <td data-bbox="1155 1603 1331 1641">3.8 mm</td> <td data-bbox="1335 1603 1481 1641">1 mm</td> </tr> <tr> <td data-bbox="799 1648 1150 1686">Tubeless</td> <td data-bbox="1155 1648 1331 1686">3.8 mm</td> <td data-bbox="1335 1648 1481 1686">1 mm</td> </tr> <tr> <td data-bbox="799 1693 1150 1776">For racing purpose only</td> <td data-bbox="1155 1693 1331 1776">3.8 mm</td> <td data-bbox="1335 1693 1481 1776">1 mm</td> </tr> <tr> <td data-bbox="799 1783 1150 1821">CIK - Option</td> <td data-bbox="1155 1783 1331 1821">5 mm</td> <td data-bbox="1335 1783 1481 1821">2 mm</td> </tr> <tr> <td data-bbox="799 1827 1150 1865">Barcode</td> <td data-bbox="1155 1827 1331 1865"></td> <td data-bbox="1335 1827 1481 1865"></td> </tr> <tr> <td data-bbox="799 1872 1150 1910"></td> <td data-bbox="1155 1872 1331 1910"></td> <td data-bbox="1335 1872 1481 1910"></td> </tr> <tr> <td data-bbox="799 1917 1150 1955"></td> <td data-bbox="1155 1917 1331 1955"></td> <td data-bbox="1335 1917 1481 1955"></td> </tr> </tbody> </table>	Texte / Text	Hauteur / Height	Trait / Stroke	VEGA	16.5 mm	4.5/9.5	10 x 7.10 – 5	10 mm	4 mm	Made in Italy	3.8 mm	1 mm	Tubeless	3.8 mm	1 mm	For racing purpose only	3.8 mm	1 mm	CIK - Option	5 mm	2 mm	Barcode										
	Texte / Text	Hauteur / Height	Trait / Stroke																														
	VEGA	16.5 mm	4.5/9.5																														
	10 x 7.10 – 5	10 mm	4 mm																														
	Made in Italy	3.8 mm	1 mm																														
	Tubeless	3.8 mm	1 mm																														
	For racing purpose only	3.8 mm	1 mm																														
	CIK - Option	5 mm	2 mm																														
	Barcode																																
VEGA	16.5 mm	4.5/9.5																															
10 x 7.10 – 5	10 mm	4 mm																															
Made in Italy	3.8 mm	1 mm																															
Tubeless	3.8 mm	1 mm																															
For racing purpose only	3.8 mm	1 mm																															
CIK - Option	5 mm	2 mm																															
Barcode																																	